

1



welcome to  
nhow Frankfurt



1

nhow  
FRANKFURT





nhow  
FRANKFURT



# nhow Frankfurt the art of money



nft skybar  
& restaurant

## welcome

to nhow Frankfurt – a design & lifestyle hotel where the art of money is lived and experienced throughout. The hotel is based in the skyscraper “ONE by CA Immo”, and fits perfectly into the financial hotspot of Frankfurt. It offers guests a unique hotel experience, right in the booming European Quarter and located next to the Frankfurt fair. A place of inspiration, relaxation and creative exchange. Are you ready to feel like gold?

## hotel & location

Frankfurt Airport: 15km / 15min by car  
Frankfurt Station: 900m / 10min by foot  
Frankfurt Messe: 100m / 2min by foot  
Public transport: Subway, train, tram & bus < 2min away  
Parking: 150 spaces below the building

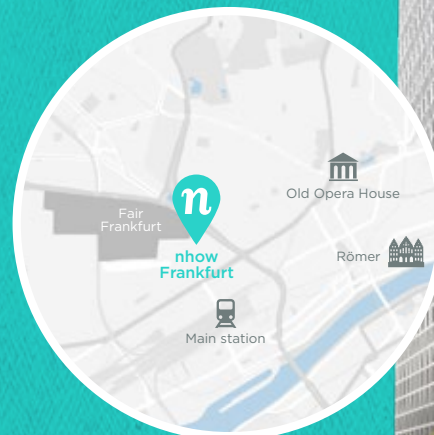





## 375 inspiring rooms

divided over 11 floors, the rooms offer maximum comfort and will surprise guests with unexpected details. Always with a hint of mischief, the theme comes to life in various elements in these well designed and inspiring rooms.





## & there is more

to discover in this impressive building. On the ground floor you will find the Rich Barista coffee shop, where you can start your day with a freshly brewed cup of coffee and take a snack on the go. For those going the extra mile, we have a special Insider lounge where you can feel like a real VIP, with unlimited drinks & snacks for those who book our suites or lounge rooms.

## relax & unwind

after a hard day of earning (or spending) money, you can sit down in our Gold Bar to enjoy a cocktail or a good glass of wine. Or break a sweat after a busy day of working in our state-of-the-art fitness center. If you'd rather take it easy, enjoy our spa area with sauna.



The image shows a modern restaurant interior. In the foreground, there is a long bar with a black countertop and a decorative perforated metal front panel that glows with warm light. The bar is stocked with various bottles of alcohol, glasses, and fresh fruit. Behind the bar, there are shelves filled with more bottles. To the left, a lounge area with colorful armchairs and a table is visible. The ceiling features a complex, geometric lighting structure. The entire scene is framed by a decorative teal border with intricate patterns.

## eat & connect

in one of our restaurants, one located on the 1st floor with an inspiring and vibrant design and full of natural daylight, the perfect place to start your day with a fluffy stack of pancakes, a freshly baked croissant and a strong cup of coffee.

## visit our nft skybar & restaurant

and take it to the next level. Located on the 47th floor with stunning views over the city of Frankfurt, it is the perfect place to enjoy the sunset and take in some fresh air on the outdoor terrace.





## host a meeting or event

in one of our 18 meeting rooms, with endless flexibility to host events for up to 500 people. From small conferences to cocktail events, there is always a space that fits your needs. Our meeting rooms are located on the 2nd and 3rd floor, with plenty of space in our trading area to connect, grab a coffee, or just take a well-deserved break from a long meeting.







# capacity chart

meeting room	L x W (m)	room size (m <sup>2</sup> )	classroom	u shape	theatre	board	chair circle	cabaret	banquet	cocktail	daylight
colom	13,90 x 7,50	116	45	35	64	30	40	30	48	60	✓
franc	13,90 x 7,50	116	45	35	64	30	40	30	48	60	✓
colom + franc	27,70 x 7,50	232	78	-	120	-	-	60	96	120	✓
baht	11,10 x 5,80	71	20	20	50	20	30	-	-	-	✓
euro	7,30 x 5,80	47	12	16	28	12	20	-	-	-	✓
baht + euro	18,30 x 5,80	118	36	36	70	-	-	45	72	64	✓
dollar	7,20 x 5,80	47	12	16	28	12	20	-	-	-	✓
yen	7,20 x 5,80	46	12	12	18	8	12	-	-	-	✓
dollar + yen	14,40 x 5,80	93	28	28	50	20	30	25	40	56	✓
lira	7,20 x 5,80	45	12	12	24	12	20	-	-	-	✓
pound*	3,60 x 5,80	37	-	-	-	-	-	-	-	14	✓
rupee*	7,00 x 8,40	73	-	-	-	-	-	-	-	30	✓
schilling (BOARD)	4,80 x 5,80	28	-	-	-	8	-	-	-	-	✓
naira	13,90 x 7,50	116	45	35	64	30	40	30	48	60	✓
shekel	13,90 x 7,50	116	45	35	64	30	40	30	48	60	✓
naira + shekel	27,70 x 7,50	232	78	-	120	-	-	60	96	120	✓
antiles guilder	10,50 x 5,50	67	16	16	40	16	25	-	-	-	✓
hryvna	7,20 x 5,50	44	12	12	24	12	20	-	-	-	✓
antiles guilder + hryvna	18,20 x 5,50	111	32	32	50	-	-	35	56	56	✓
won	4,80 x 5,50	30	-	8	10	8	13	-	-	-	✓
kips	4,80 x 5,50	29	-	6	10	4	13	-	-	-	✓
won + kips	9,60 x 5,50	59	16	20	30	16	20	-	-	28	✓
peso*	15,80 x 5,50	97	-	-	-	-	-	-	-	40	✓
forint (BOARD)	4,80 x 5,50	27	-	-	-	8	-	-	-	-	✓

\* Lounge style meeting space, perfect for creative brainstorming and get-togethers

# meeting facilities

2nd  
floor



3rd  
floor

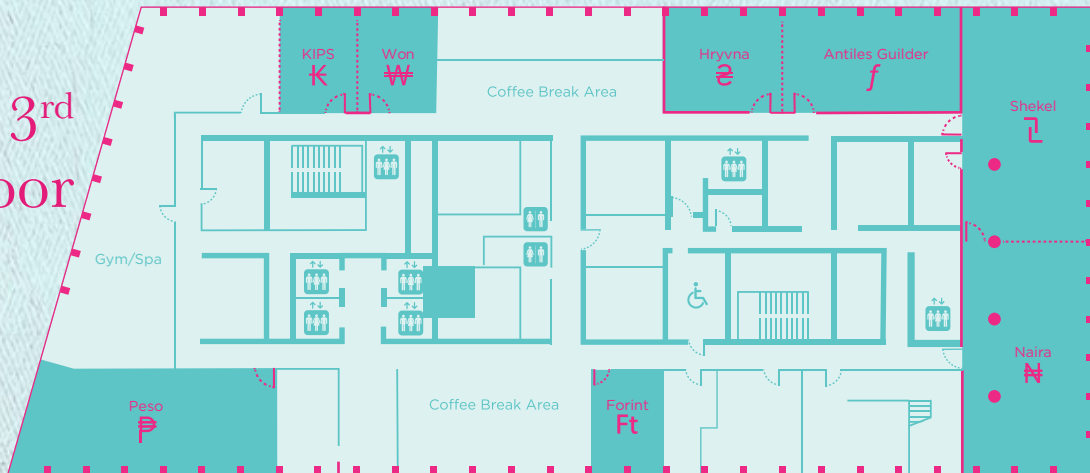





**n**  
nhow  
London

nhow  
Rotterdam

**n n**

nhow  
Amsterdam RAI

**n**

nhow  
Brussels

**n**

nhow  
Frankfurt

**n**

nhow  
Berlin

**n**

nhow  
Marseille

**n**

nhow  
Milano

**n**

nhow  
Roma  
coming soon!

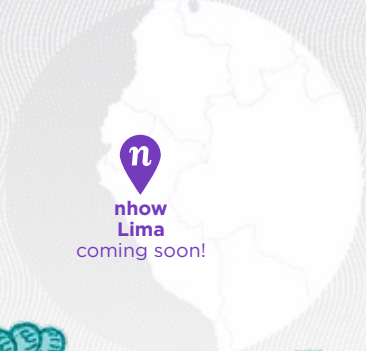

**n**

nhow  
Lima  
coming soon!

### contact

nhgroupsales.de@nh-hotels.com | +49 (0)3022380135  
Brüsseler Str. 1-3, 60327, Frankfurt am Main, Germany

[nhow-frankfurt.com](http://nhow-frankfurt.com) | [nhow-hotels.com](http://nhow-hotels.com)